

ADDENDUM NO. 1

August 24, 2022

This Addendum contains changes to the requirements of the Contract Documents and Specifications. Such changes are to be incorporated into the Construction Documents and shall apply to the work with the same meaning and force as if they had been included in the original document. Wherever this Addendum modifies a portion of a paragraph of the specifications or a portion of any Drawing, the remainder of the Paragraph or Drawing shall remain in force.

NOTE: Provisions of all Contract Documents apply.

Item 1. Drawing A101

DELETE in its entirety.

REPLACE with revised Drawing A101R1, attached.

Item 2. Drawing A151

DELETE in its entirety.

REPLACE with revised Drawing A151R1, attached.

Item 3. Section 06 10 53 Miscellaneous Rough Carpentry, Part 2

ADD:

2.5 FIRE-RETARDANT POLY SHEETING

- A. Temporary construction poly plastic sheeting: Six mil thick polyethylene film with flame retardant additives.
 - 1. Fire retardant: Passes NFPA 701-15 Flammability Standard, test 1.
 - 2. Tear strength: ASTM D-1992.
 - 3. Tensile strength and elongation: ASTM: D-882.
 - 4. Color: White.
 - 5. Basis of design: Global Plastic Sheeting, Inc., ASFR-6, or approved equal.
- B. Attachment: Adhesive tape per manufactures recommendation.

Item 4. RFI Questions and Clarifications

See attached RFI Log (1 - 4)

Modify Atrium Lighting & Sprinklers – Mann Library - REBID
Addendum No, 1
August 24, 2022
Page 2

Attachments Drawing A101R1
 Drawing A151R1
 Section 06 10 53 Paragraph 2.5 FIRE-RETARDANT POLY SHEETING
 RFI Log (1 – 4)

******END OF ADDENDUM******

1 2 3 4 5 6 7 8 9 10

G

F

E

D

C

B

A

A1 FIRST FLOOR PLAN
1/8" = 1'-0"

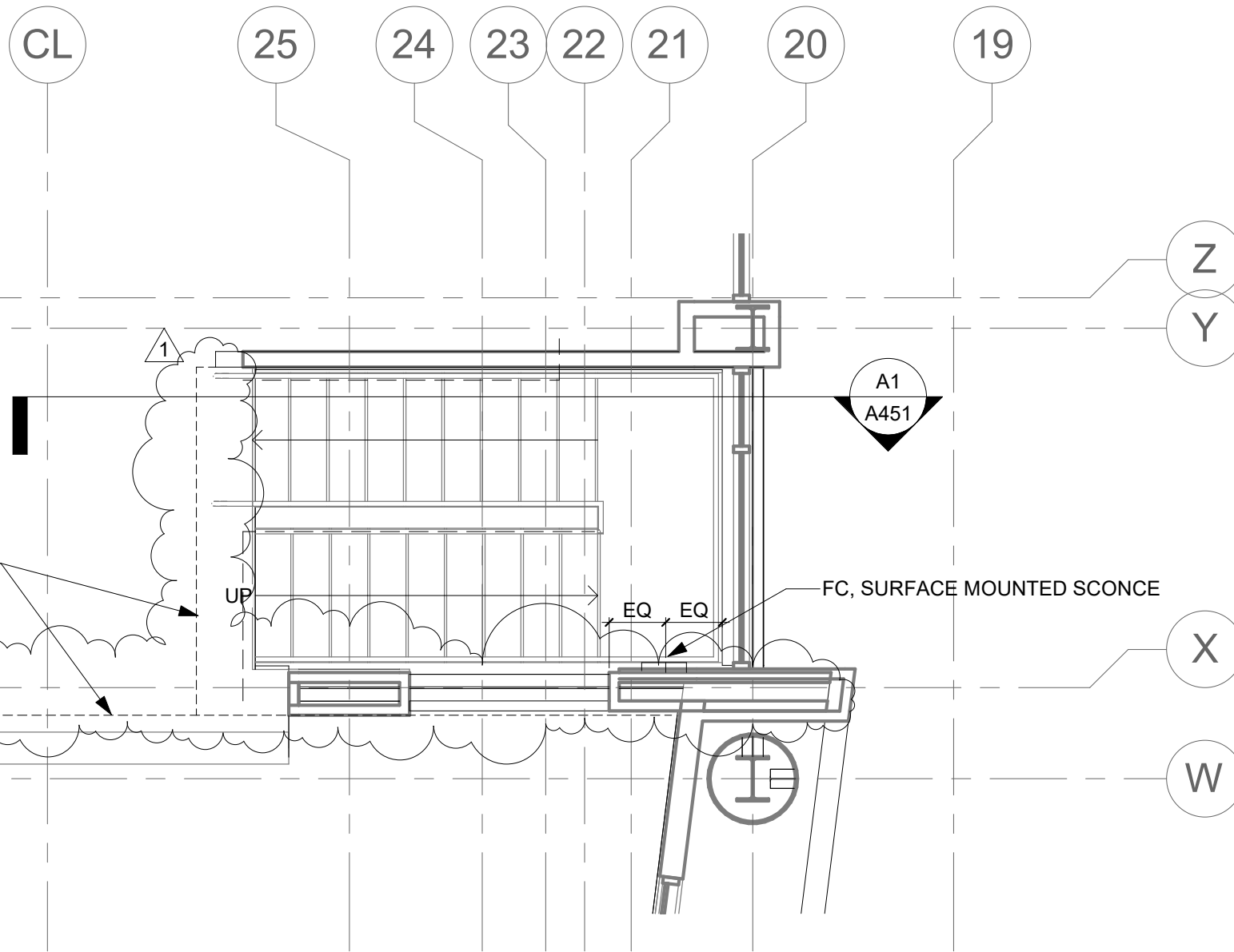
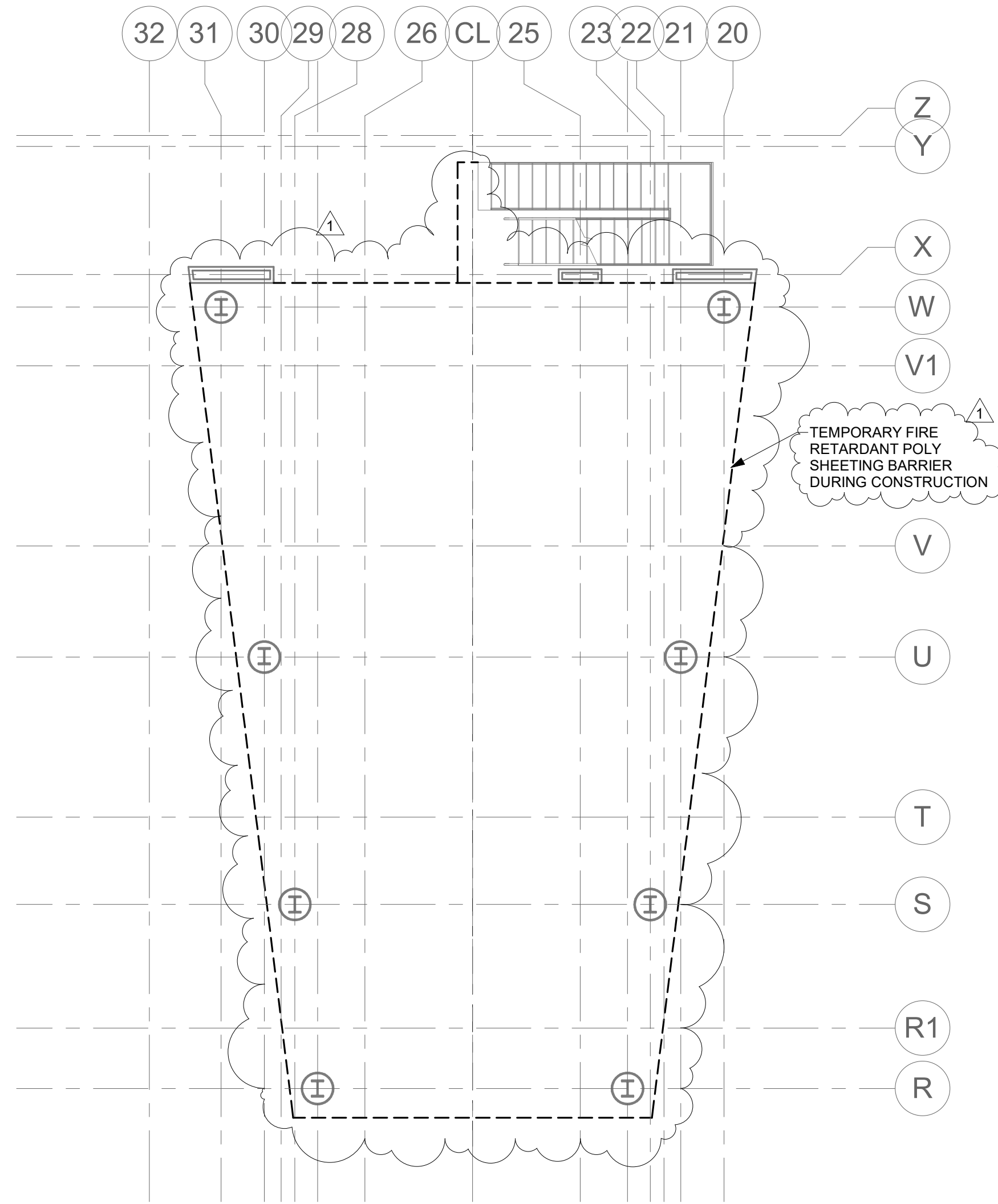

E4 FOURTH FLOOR PLAN
1/4" = 1'-0"

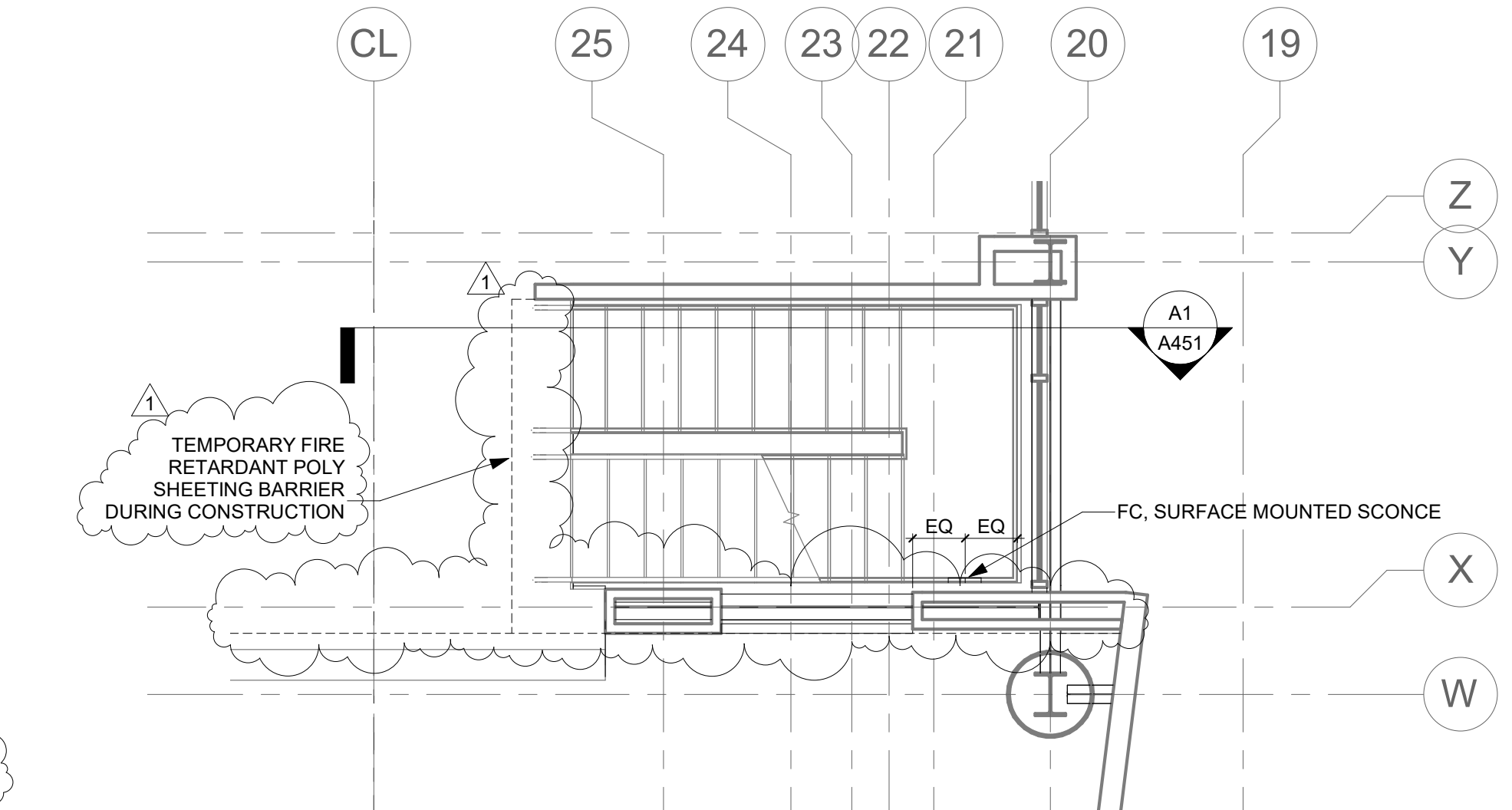

C4 THIRD FLOOR PLAN
1/4" = 1'-0"

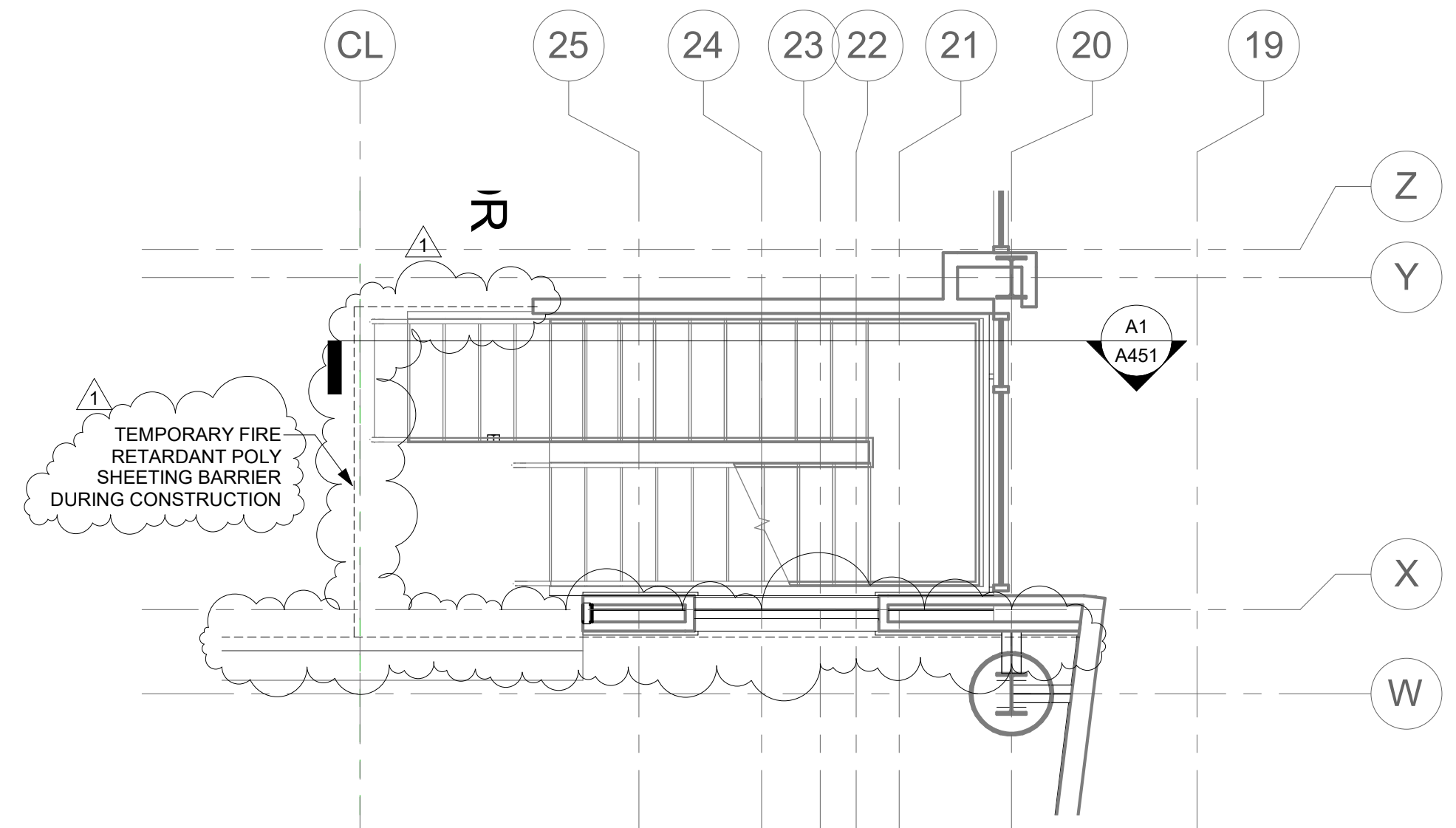

A4 SECOND FLOOR PLAN
1/4" = 1'-0"

- NOTES:
1. INSTALL TEMPORARY FIRE RETARDANT POLY BARRIER DURING CONSTRUCTION TO LIMIT ACCESS AND PREVENT DUST FROM SPREADING. TAPE EDGES OF BARRIER AS REQUIRED TO PREVENT DUST MITIGATION.
 2. TEMPORARY FIRE RETARDANT POLY BARRIER AT ALL ENTRANCES TO STAIR 5 IS TO BE INSTALLED ONLY WHEN REQUIRED. STAIR 5 TO BE LEFT AVAILABLE FOR USE AT ALL OTHER TIMES.
 3. WINDOWS ARE TO BE CLEANED WHEN CONSTRUCTION IS SUBSTANTIALLY COMPLETE PRIOR TO REMOVAL OF SCAFFOLDING.
 4. MATS ON ROOF ARE TO MATCH PERFORMANCE OF EXISTING. QUANTITY AND LENGTH IS TO BE FIELD VERIFIED.

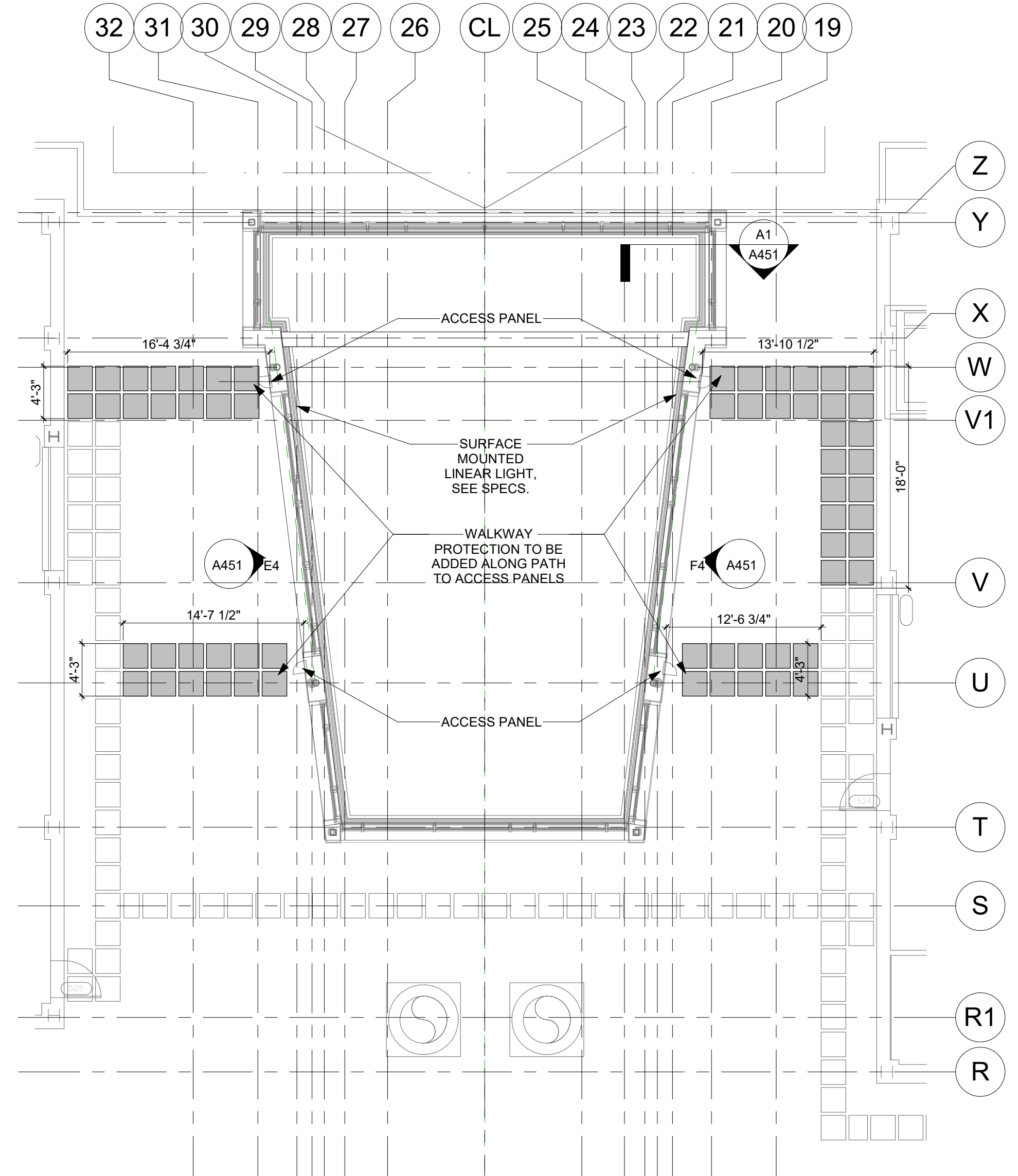

D7 ROOF FLOOR PLAN
1/8" = 1'-0"

Chiang | O'Brien
ARCHITECTS



WARNING: It is a violation of New York State Law for any person, unless acting under the direction of a licensed Architect, to alter this document in any way. If a document bearing the seal of an Architect is altered, the altering Architect shall affix to such document his seal and the notation "altered by" followed by his signature, the date of such alteration, and a specific description of the alteration.

REVISION SCHEDULE		
#	DESCRIPTION	DATE
1	ADD. 1	08/24/22

100% CONSTRUCTION DOCUMENTS
SUCF 161039 - Modify Atrium
Lighting & Sprinklers-Mann Library
 237 Mann Drive, Ithaca, NY 14853

DATE:	August 24, 2022
PROJECT:	COB# 2017
OTHER:	
DRAWN BY:	LH

PARTIAL
FLOOR PLANS

A101R1

1 2 3 4 5 6 7 8 9 10

OTHER:	LIGHT FIXTURES:	CEILING MATERIALS:	REFLECTED CEILING PLAN NOTES:
<ul style="list-style-type: none"> SPRINKLER HEAD 	<ul style="list-style-type: none"> LINEAR SURFACE MOUNTED UPLIGHT FIXTURE RECESSED LINEAR LIGHT FIXTURE (OPTION 1) RECESSED CAN LIGHT FIXTURE (OPTION 2) 	<ul style="list-style-type: none"> GYPSUM BOARD CEILING 	<p>1. ALL GYPSUM SOFFITS ARE TO BE PATCHED AND PAINTED TO MATCH EXISTING FINISH.</p>

LIGHTING FIXTURE SCHEDULE										
LABEL	DESCRIPTION	MANUFACTURER	MODEL	VOLTAGE	LAMP TYPE	TOTAL WATTS	FINISH	MOUNTING	DRIVER LOCATION	NOTES
FA	SURFACE MOUNTED IN ARCHITECTURAL COVE CONTINUOUS LINEAR LED UPLIGHT WITH 120" DISTRIBUTION AND INTEGRAL DIMMING DRIVER.	ECOSENSE	L35-(LENGTH)-12-35-80-MULT-120	PER EE	3500K WHITE LED	12W/LF	-	SURFACE MOUNTED	INTEGRAL	MOCKUP REQUIRED: LINEAR FIXTURE IS TO DELIVER A 120° BEAM ANGLE AND TO BE CONCEALED WITHIN COVE LIGHTING SHELF. OUTPUT IS TO PROVIDE A FLICKER FREE DIMMING DOWN TO 0%. LISTED MANUFACTURER OR EQUAL ARE.
FB	RECESSED FLANGELESS LED DOWNLIGHT WITH NOMINAL 4" DIAMETER APERTURE, DIFFUSE SATIN OPAL LENS, AND INTEGRAL DIMMING DRIVER.	INTER-LUX WHITEGOODS	WG-100RPTD-RPT-H-935-(DRIVER)-FR0D-LAM-(FINISH)-(OPTIONS)	PER EE	3500K WHITE LED	23W	WHITE	RECESSED	INTEGRAL	ROUND RECESSED 4" DIAMETER WITH FLUSH PLASTER TRIM AND INTEGRAL DRIVER. FIXTURE AND DRIVER DEPTH TO BE NO MORE THAN 3.3". LISTED MANUFACTURER OR EQUAL ARE ACCEPTABLE REPLACEMENTS.
FC	12" DIAMETER DECORATIVE WALL MOUNTED SCONCE	KONCEPT	RMW-12-SW-PTB-HW	120	3000K WHITE LED	18W	PAINTABLE	SURFACE MOUNTED	INTEGRAL	ROUND 12" DIAMETER WITH INTERCHANGEABLE MAGNETICALLY ATTACHED FACE PLATES. ROUND BOWL SHAPE BODY IS TO EMIT 360° OF DIFFUSED LIGHT. LISTED MANUFACTURER OR EQUAL ARE ACCEPTABLE REPLACEMENTS.

Chiang | O'Brien ARCHITECTS

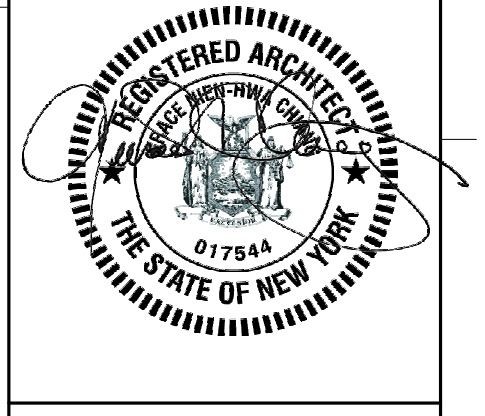

WARNING: It is a violation of New York State Law for any person, unless acting under the direction of a licensed Architect, to alter this document in any way. If a document bearing the seal of an Architect is altered, the altering Architect shall affix to such document his seal and the notation "altered by" followed by his signature, the date of such alteration, and a specific description of the alteration.

REVISION SCHEDULE		
#	DESCRIPTION	DATE
1	ADD. 1	08/24/22

G
F
E
D
C
B
A

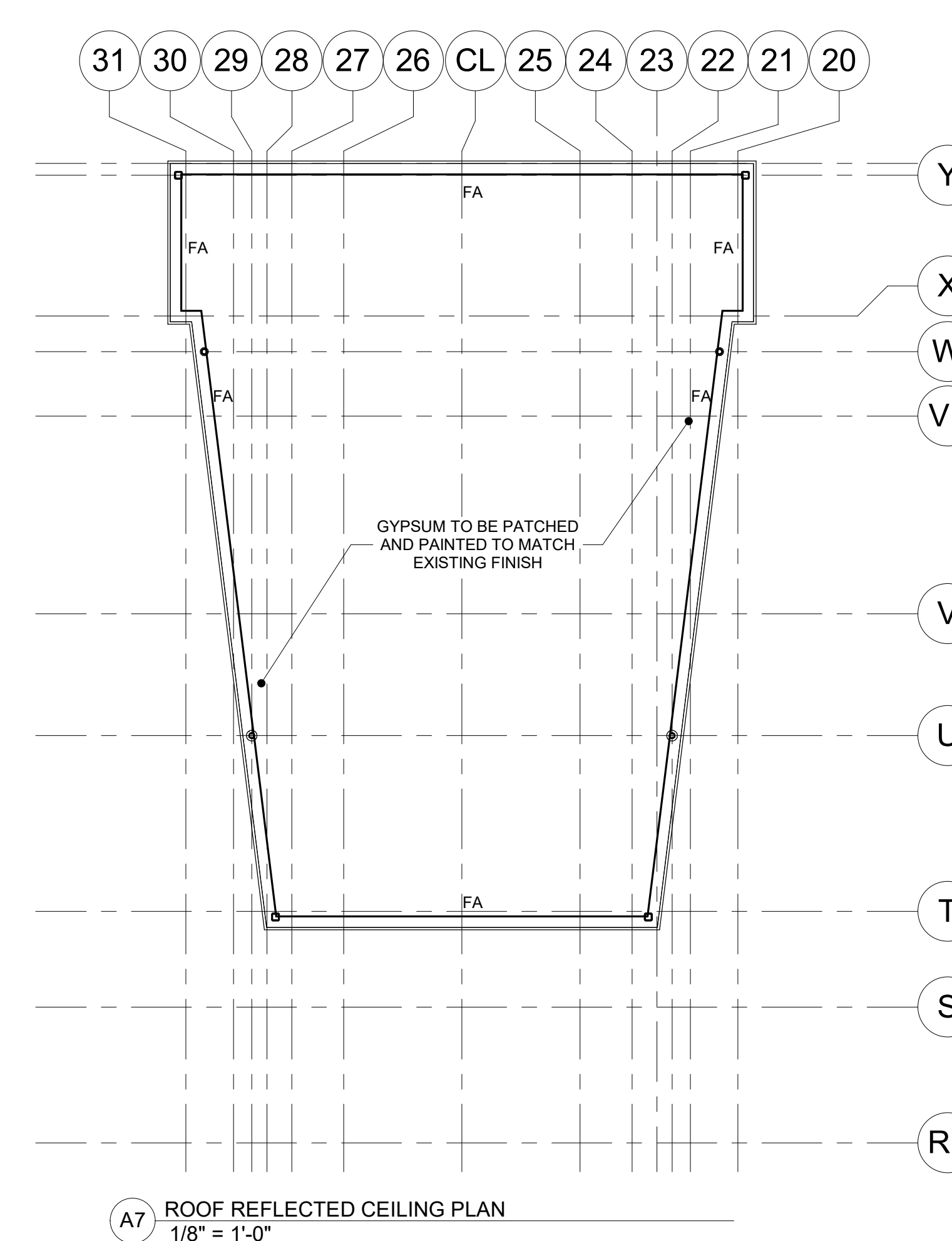
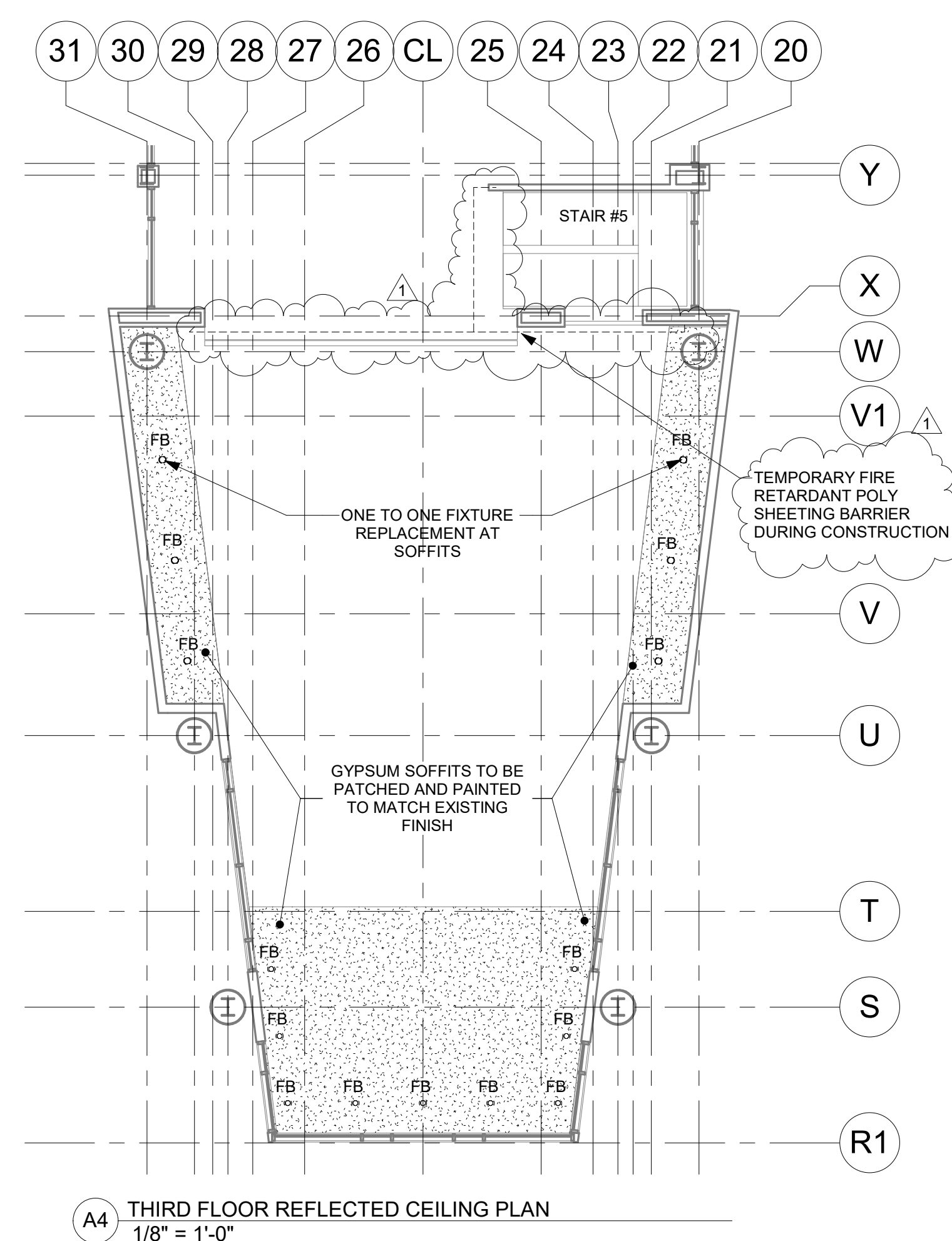
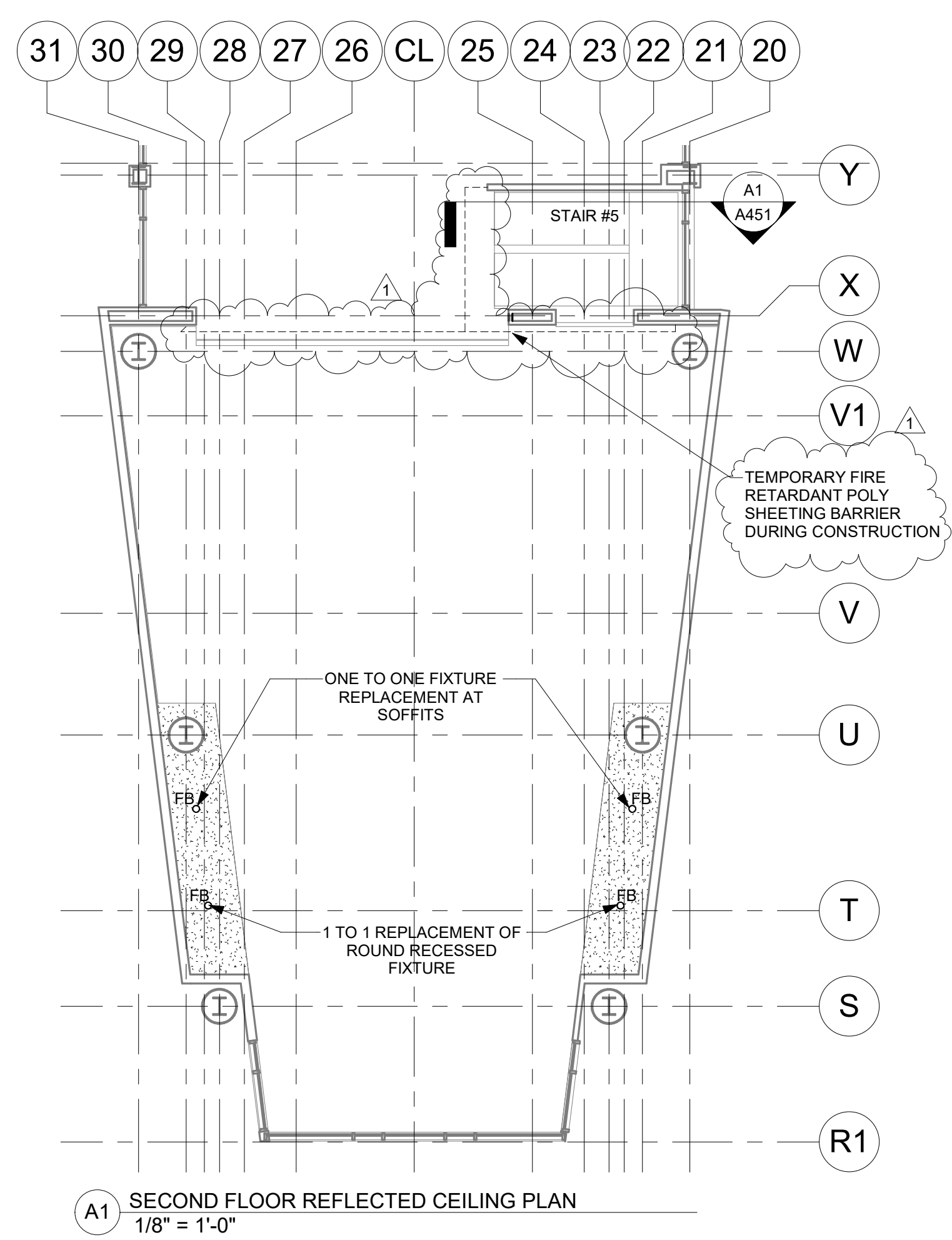

1 2 3 4 5 6 7 8 9 10

100% CONSTRUCTION DOCUMENTS
SUCF 161039 - Modify Atrium Lighting & Sprinklers-Mann Library
 237 Mann Drive, Ithaca, NY 14853

DATE:	August 24, 2022
PROJECT:	COB# 2017
OTHER:	
DRAWN BY:	LH

PARTIAL REFLECTED CEILING PLANS

A151R1

F
E
D
C
B
A

RFI Form

RFI/ Response Index	Page/ Dwg./Spec./Rep. Number	Section/ Paragraph/Topic	RFI	Design Team Response
1	Specifications		Fixture schedule or approved fixture descriptive in the specifications section is missing.	See Addendum No. 1, Item 2. The fixture schedule can be found in Drawing A151R1. Fixture description and specification can be found in Specification 26 51 00 ARCHITECTURAL LIGHTING FIXTURES.
2			Can poly plastic sheeting be used instead of studs and plywood for the temporary barrier? Clarify where a barrier is needed.	See Addendum No. 1, Items 1 and 2. The install of temporary fire retardant poly barrier during construction to limit access and prevent dust from spreading is allowed. The barrier is to be installed around the perimeter of the atrium on Level 01 and around any openings within the atrium in order to prevent dust from spreading. See drawing A101R1 and A151R1.
3	Specifications		Is there a requirement for fire watch during construction?	Fire watch requirements can be found in the specifications Section 01 50 00 TEMPORARY FACILITIES AND CONTROLS.
4			Can a lift be used instead of scaffolding for the construction work?	Scaffolding is to be installed for the needed work in order to reach the ceilings within the scope.